

GRADE 5 HEX HEAD CAP SCREWS / COARSE THREAD

DIAMETER		1/4"	5/16"	3/8"	7/16"	1/2"	9/16"	5/8"
THREADS PER INCH		20	18	16	14	13	12	11
HEAD SIZE ACROSS FLATS (WRENCH SIZE)		7/16"	1/2"	9/16"	5/8"	3/4"	13/16"	7/8"
TENSILE STRENGTH		120,000 PSI	120,000 PSI	120,000 PSI	120,000 PSI	120,000 PSI	120,000 PSI	120,000 PSI
L E N G T H	1/2"	CSC-1412	CSC-51612			CSC-1212		
	3/4"	CSC-1434	CSC-51634	CSC-3834	CSC-71634	CSC-1234		
	1"	CSC-141	CSC-5161	CSC-381	CSC-7161	CSC-121	CSC-9161	CSC-581
	1-1/4"	CSC-14114	CSC-516114	CSC-38114	CSC-716114	CSC-12114		CSC-58114
	1-1/2"	CSC-14112	CSC-516112	CSC-38112	CSC-716112	CSC-12112	CSC-916112	CSC-58112
	1-3/4"	CSC-14134	CSC-516134	CSC-38134	CSC-716134	CSC-12134		CSC-58134
	2"	CSC-142	CSC-5162	CSC-382	CSC-7162	CSC-122	CSC-9162	CSC-582
	2-1/4"	CSC-14214	CSC-516214	CSC-38214	CSC-716214	CSC-12214		CSC-58214
	2-1/2"	CSC-14212	CSC-516212	CSC-38212	CSC-716212	CSC-12212	CSC-916212	CSC-58212
	3"	CSC-143	CSC-5163	CSC-383	CSC-7163	CSC-123	CSC-9163	CSC-583
	3-1/2"	CSC-14312	CSC-516312	CSC-38312	CSC-716312	CSC-12312	CSC-916312	CSC-58312
	4"	CSC-144	CSC-5164	CSC-384	CSC-7164	CSC-124	CSC-9164	CSC-584
	4-1/2"	CSC-14412	CSC-516412	CSC-38412	CSC-716412	CSC-12412	CSC-916412	CSC-58412
	5"	CSC-145	CSC-5165	CSC-385	CSC-7165	CSC-125	CSC-9165	CSC-585

Fine Thread Available On All CapScrews



GRADE 8 HEX HEAD CAP SCREWS / COARSE THREAD

DIAMETER	1/4"	5/16"	3/8"	7/16"	1/2"	9/16"	5/8"	3/4"	
THREADS PER INCH	20	18	16	14	13	12	11	10	
HEAD SIZE ACROSS FLATS	7/16"	1/2"	9/16"	5/8"	3/4"	13/16"	7/8"	1"	
TENSILE STRENGTH	150,000 PSI	150,000 PSI	150,000 PSI	150,000 PSI	150,000 PSI	150,000 PSI	150,000 PSI	150,000 PSI	
LENGTH	1/2"	CSC8-1412	CSC8-51612	CSC8-3812					
	5/8"	CSC8-1458	CSC8-51658	CSC8-3858					
	3/4"	CSC8-1434	CSC8-51634	CSC8-3834	CSC8-71634	CSC8-1234			
	1"	CSC8-141	CSC8-5161	CSC8-381	CSC8-7161	CSC8-121	CSC8-9161	CSC8-581	CSC8-341
	1-1/4"	CSC8-14114	CSC8-516114	CSC8-38114	CSC8-716114	CSC8-12114	CSC8-916114	CSC8-58114	
	1-1/2"	CSC8-14112	CSC8-516112	CSC8-38112	CSC8-716112	CSC8-12112	CSC8-916112	CSC8-58112	CSC8-34112
	1-3/4"	CSC8-14134	CSC8-516134	CSC8-38134	CSC8-716134	CSC8-12134	CSC8-916134	CSC8-58134	CSC8-34134
	2"	CSC8-142	CSC8-5162	CSC8-382	CSC8-7162	CSC8-122	CSC8-9162	CSC8-582	CSC8-342
	2-1/4"	CSC8-14214	CSC8-516214	CSC8-38214	CSC8-716214	CSC8-12214		CSC8-58214	CSC8-34214
	2-1/2"	CSC8-14212	CSC8-516212	CSC8-38212	CSC8-716212	CSC8-12212	CSC8-916212	CSC8-58212	CSC8-34212
	2-3/4"	CSC8-14234	CSC8-516234	CSC8-38234	CSC8-716234	CSC8-12234		CSC8-58234	
	3"	CSC8-143	CSC8-5163	CSC8-383	CSC8-7163	CSC8-123	CSC8-9163	CSC8-583	CSC8-343
	3-1/4"		CSC8-516314	CSC8-38314		CSC8-12314			
	3-1/2"	CSC8-14312	CSC8-516312	CSC8-38312	CSC8-716312	CSC8-12312	CSC8-916312	CSC8-58312	CSC8-34312
	4"	CSC8-144	CSC8-5164	CSC8-384	CSC8-7164	CSC8-124	CSC8-9164	CSC8-584	CSC8-344
	4-1/2"	CSC8-14412	CSC8-516412	CSC8-38412	CSC8-716412	CSC8-12412	CSC8-916412	CSC8-58412	CSC8-34412
5"	CSC8-145	CSC8-5165	CSC8-385	CSC8-7165	CSC8-125	CSC8-9165	CSC8-585	CSC8-345	
6"	CSC8-146	CSC8-5166	CSC8-386	CSC8-7166	CSC8-126	CSC8-9166	CSC8-586	CSC8-346	

Fine Thread Available On All Capscrews



USS FLAT WASHERS

USS PART#	SIZE	O.D.	STD PKG
FW-USS-10	#10	9/16"	100
FW-USS-1/4	1/4"	3/4"	100
FW-USS-5/16	5/16"	7/8"	100
FW-USS-3/8	3/8"	1"	100
FW-USS-7/16	7/16"	1-1/4"	100
FW-USS-1/2	1/2"	1-3/8"	100
FW-USS-9/16	9/16"	1-1/2"	100
FW-USS-5/8	5/8"	1-3/4"	50
FW-USS-3/4	3/4"	2"	50
FW-USS-1	1"	2-1/2"	25
FW-USS-1-1/4	1-1/4"	3"	25
FW-USS-1-1/2	1-1/2"	3-1/2"	5



GRADE 8 USS FLAT WASHERS YELLOW ZINC CHROMATE (HEAVY DUTY)

USS PART#	SIZE	O.D.	STD PKG
FW8-USS-1/4	1/4"	3/4"	100
FW8-USS-5/16	5/16"	7/8"	100
FW8-USS-3/8	3/8"	1"	100
FW8-USS-7/16	7/16"	1-1/4"	100
FW8-USS-1/2	1/2"	1-3/8"	100
FW8-USS-9/16	9/16"	1-1/2"	50
FW8-USS-5/8	5/8"	1-3/4"	50
FW8-USS-3/4	3/4"	2"	50
FW8-USS-7/8	7/8"	2-1/4"	25
FW8-USS-1	1"	2-1/2"	10



SAE FLAT WASHERS

SAE PART#	SIZE	O.D.	STD PKG
FW-SAE-4	#4	5/16"	100
FW-SAE-6	#6	3/8"	100
FW-SAE-8	#8	7/16"	100
FW-SAE-10	#10	1/2"	100
FW-SAE-12	#12	9/16"	100
FW-SAE-1/4	1/4"	5/8"	100
FW-SAE-5/16	5/16"	11/16"	100
FW-SAE-3/8	3/8"	13/16"	100
FW-SAE-7/16	7/16"	15/16"	100
FW-SAE-1/2	1/2"	1"	100
FW-SAE-9/16	9/16"	1-3/16"	100
FW-SAE-5/8	5/8"	1-5/16"	100
FW-SAE-3/4	3/4"	1-1/2"	100
FW-SAE-7/8	7/8"	1-3/4"	100
FW-SAE-1	1"	2"	50



GRADE 8 SAE PLATED FLAT WASHERS YELLOW ZINC CHROMATE (HEAVY DUTY)

SAE PART#	SIZE	O.D.	STD PKG
FW8HD-SAE-1/4	1/4"	5/8"	100
FW8HD-SAE-5/16	5/16"	11/16"	100
FW8HD-SAE-3/8	3/8"	13/16"	100
FW8HD-SAE-7/16	7/16"	15/16"	100
FW8HD-SAE-1/2	1/2"	1"	100
FW8HD-SAE-9/16	9/16"	1-3/16"	50
FW8HD-SAE-5/8	5/8"	1-5/16"	50
FW8HD-SAE-3/4	3/4"	1-1/2"	50
FW8HD-SAE-7/8	7/8"	1-3/4"	25
FW8HD-SAE-1	1"	2"	10



STAR LOCK WASHERS



EXTERNAL PART#	INTERNAL PART#	EXTERNAL-INTERNAL PART#	STUD SIZE	STD PKG
LWE-10		LWEI-10	#10	100
LWE-1/4	LWI-1/4	LWEI-1/4	1/4"	100
LWE-5/16	LWI-5/16	LWEI-5/16	5/16"	100
LWE-3/8	LWI-3/8	LWEI-3/8	3/8"	100
LWE-7/16	LWI-7/16		7/16"	100
LWE-1/2	LWI-1/2		1/2"	100
	LWI-5/8		5/8"	100

LOCK WASHERS



PART#	SIZE	STD PKG
LW-8	#8	100
LW-10	#10	100
LW-1/4	1/4"	100
LW-5/16	5/16"	100
LW-3/8	3/8"	100
LW-7/16	7/16"	100
LW-1/2	1/2"	100
LW-9/16	9/16"	100
LW-5/8	5/8"	50
LW-3/4	3/4"	50
LW-1	1"	50

GRADE 8 YELLOW ZINC LOCK WASHERS



PART#	SIZE	STD PKG
LW8-1/4	1/4"	100
LW8-5/16	5/16"	100
LW8-3/8	3/8"	100
LW8-7/16	7/16"	50
LW8-1/2	1/2"	50
LW8-9/16	9/16"	50
LW8-5/8	5/8"	25
LW8-3/4	3/4"	25
LW8-7/8	7/8"	25
LW8-1	1"	10

FENDER WASHERS

PART#	I.D.	O.D.	THICKNESS	STD PKG
FNW-316X1	3/16"	1"	.047" - .080"	100
FNW-316X114	3/16"	1-1/4"	.047" - .080"	100
FNW-14X1	1/4"	1"	.047" - .080"	100
FNW-14X114	1/4"	1-1/4"	.047" - .080"	100
FNW-14X112	1/4"	1-1/2"	.047" - .080"	100
FNW-516X114	5/16"	1-1/4"	.047" - .080"	100
FNW-516X112	5/16"	1-1/2"	.047" - .080"	100
FNW-38X112	3/8"	1-1/2"	.047" - .080"	100
FNW-12X2	1/2"	2"	.047" - .080"	100



EXTRA THICK FENDER WASHERS

PART#	I.D.	O.D.	THICKNESS	STD PKG
FNWHD-14X1	1/4"	1"	.120"	100
FNWHD-14X112	1/4"	1-1/2"	.120"	100
FNWHD-516X114	5/16"	1-1/4"	.120"	50
FNWHD-516X134	5/16"	1-3/4"	.120"	50
FNWHD-38X114	3/8"	1-1/4"	.120"	50
FNWHD-38X134	3/8"	1-3/4"	.120"	50
FNWHD-12X2	1/2"	2"	.120"	50

All Hex Nuts Avliable In Fine Thread

PREVAILING TORQUE LOCK NUTS



CLASS C - WAXED

PART#	SIZE	STD PKG
HNPTC-1/4	1/4-20	100
HNPTC-5/16	5/16-18	100
HNPTC-3/8	3/8-16	100
HNPTC-7/16	7/16-14	50
HNPTC-1/2	1/2-13	50
HNPTC-9/16	9/16-12	50
HNPTC-5/8	5/8-11	25
HNPTC-3/4	3/4-10	20
HNPTC-7/8	7/8-9	25
HNPTC-1	1-8	10

NYLON LOCK NUTS

GRADE A



USS (COARSE)		
PART#	SIZE	STD PKG
NNC-10	10-24	100
NNC-1/4	1/4-20	100
NNC-5/16	5/16-18	100
NNC-3/8	3/8-16	50
NNC-7/16	7/16-14	50
NNC-1/2	1/2-13	50
NNC-9/16	9/16-12	50
NNC-5/8	5/8-11	25
NNC-3/4	3/4-10	20
SAE (FINE)		
PART#	SIZE	STD PKG
NNF-10	10-32	100
NNF-1/4	1/4-28	100
NNF-5/16	5/16-24	100
NNF-3/8	3/8-24	100
NNF-7/16	7/16-20	50
NNF-1/2	1/2-20	50
NNF-5/8	5/8-18	25

YELLOW ZINC HEXAGON NUTS



GRADE 8 COARSE		
PART#	SIZE	STD PKG
HNC8-1/4	1/4-20	100
HNC8-5/16	5/16-18	100
HNC8-3/8	3/8-16	100
HNC8-7/16	7/16-14	50
HNC8-1/2	1/2-13	50
HNC8-9/16	9/16-12	50
HNC8-5/8	5/8-11	25
HNC8-3/4	3/4-10	20
HNC8-7/8	7/8-9	15
HNC8-1	1-8	10
GRADE 8 FINE		
PART#	SIZE	STD PKG
HNF8-1/4	1/4-28	100
HNF8-5/16	5/16-24	100
HNF8-3/8	3/8-24	100
HNF8-7/16	7/16-20	50
HNF8-1/2	1/2-20	50
HNF8-5/8	5/8-18	25

HEXAGON NUTS ZINC

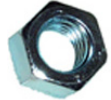

GRADE 5 COARSE		
PART#	SIZE	STD PKG
HNC5-1/4	1/4-20	100
HNC5-5/16	5/16-18	100
HNC5-3/8	3/8-16	100
HNC5-7/16	7/16-14	50
HNC5-1/2	1/2-13	50
HNC5-5/8	5/8-11	25
HNC5-3/4	3/4-10	20
HNC5-1	1-8	10
GRADE 5 FINE		
PART#	SIZE	STD PKG
HNF5-5/16	5/16-24	100
HNF5-3/8	3/8-24	100
HNF5-7/16	7/16-20	50
HNF5-1/2	1/2-20	50

"U" TYPE NUTS

 PART # UNC-1/4 Thread Size 1/4-20 Panel Range .025-.150 Center Hole to Edge 27/32" Ford Products, Late Model Standard Package - 50	 PART # UNC-5/16 Thread Size 5/16-18 Panel Range .025-.150 Center Hole to Edge 7/8" GM & Ford Products, Late Model Standard Package - 25	 PART # UNC-3/8 Thread Size 3/8-16 Panel Range .025-.200 Center Hole to Edge 1-1/8" Ford Products, Late Model Standard Package - 25
---	---	---

GENERAL PURPOSE SPRING NUTS (UNPLATED)



PART#	THREAD SIZE	PANEL RANGE	CENTER HOLD TO EDGE	STD PKG
SN-6	No. 6	.025/.125	3/8"	100
SN-8	No. 8	.025/.125	3/8"	100

LICENSE PLATE - BOLT AND NUT

 PART#: LPB-HN 1/4" - 20 x 1/2" Zinc Truss Philips Bolt; with Hex Nut. Standard Package: 100	 PART#: LPB-SN 1/4" - 20 x 1/2" Zinc Truss Philips Bolt; with Sqare Nut. Standard Package: 100
---	---

CASE HARDENED SERRATED FLANGE NUTS



PART#	THREAD SIZE	STD PKG
HNCFL-10	10-24	100
HNCFL-1/4	1/4-20	100
HNCFL-5/16	5/16-18	100
HNCFL-3/8	3/8-16	100
HNCFL-1/2	1/2-13	25
HNCFL-5/8	5/8-11	25

MACHINE NUTS



PART#	SIZE	STD PKG
MHN-632	6-32	100
MHN-832	8-32	100
MHN-1024	10-24	100
MHN-1032	10-32	100
MHN-1224	12-24	100
MHN-1420	1/4-20	100

FORGED WING NUTS



USS (Coarse)		
PART#	SIZE	STD PKG
WNC-1/4	1/4-20	100
WNC-5/16	5/16-18	50
WNC-3/8	3/8-16	50
WNC-1/2	1/2-13	25

KEP NUTS



PART#	SIZE	STD PKG
KNC-6	6-32	100
KNC-8	8-32	100
KNC-10	10-24	100
KNC-1/4	1/4-20	100
KNC-5/16	5/16-18	100
KNC-3/8	3/8-16	100

Metric Hex Head Cap Screws

8.8 & 10.9 Available

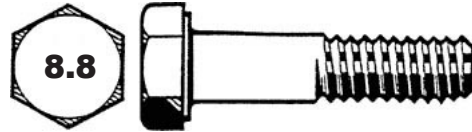

**CARBON
STEEL**



REGULAR PITCH — GRADE 8.8

PART#	DIA.	PITCH	HEAD	LENGTH	STD PKG
CSM-5X10	5MM	.80	8MM	10MM	100
CSM-5X20	5MM	.80	8MM	20MM	100
CSM-5X25	5MM	.80	8MM	25MM	100
CSM-5X30	5MM	.80	8MM	30MM	100
CSM-6X10	6MM	1.0	10MM	10MM	100
CSM-6X12	6MM	1.0	10MM	12MM	100
CSM-6X16	6MM	1.0	10MM	16MM	100
CSM-6X20	6MM	1.0	10MM	20MM	100
CSM-6X25	6MM	1.0	10MM	25MM	100
CSM-6X30	6MM	1.0	10MM	30MM	100
CSM-6X35	6MM	1.0	10MM	35MM	100
CSM-6X40	6MM	1.0	10MM	40MM	100
CSM-6X45	6MM	1.0	10MM	45MM	100
CSM-8X10	8MM	1.25	13MM	10MM	100
CSM-8X12	8MM	1.25	13MM	12MM	100
CSM-8X16	8MM	1.25	13MM	16MM	50
CSM-8X20	8MM	1.25	13MM	20MM	50
CSM-8X25	8MM	1.25	13MM	25MM	50
CSM-8X30	8MM	1.25	13MM	30MM	50
CSM-8X35	8MM	1.25	13MM	35MM	50
CSM-8X40	8MM	1.25	13MM	40MM	50
CSM-8X45	8MM	1.25	13MM	45MM	50
CSM-8X50	8MM	1.25	13MM	50MM	50

PART#	DIA.	PITCH	HEAD	LENGTH	STD PKG
CSM-10X20	10MM	1.50	16MM	20MM	50
CSM-10X25	10MM	1.50	16MM	25MM	50
CSM-10X30	10MM	1.50	16MM	30MM	50
CSM-10X35	10MM	1.50	16MM	35MM	50
CSM-10X40	10MM	1.50	16MM	40MM	50
CSM-10X45	10MM	1.50	16MM	45MM	25
CSM-10X50	10MM	1.50	16MM	50MM	25
CSM-10X55	10MM	1.50	16MM	55MM	25
CSM-10X60	10MM	1.50	16MM	60MM	25
CSM-12X25	12MM	1.75	18MM	25MM	25
CSM-12X30	12MM	1.75	18MM	30MM	25
CSM-12X35	12MM	1.75	18MM	35MM	25
CSM-12X40	12MM	1.75	18MM	40MM	25
CSM-12X50	12MM	1.75	18MM	50MM	10
CSM-12X55	12MM	1.75	18MM	55MM	10
CSM-12X60	12MM	1.75	18MM	60MM	10

HEX NUTS GRADE 8.8

PART#	SIZE (MM)	PITCH	STD PKG
HNM-4	4	.70	100
HNM-5	5	.80	100
HNM-6	6	1.00	100
HNM-8	8	1.25	100
HNM-10	10	1.50	25
HNM-12	12	1.75	25
HNM-14	14	2.00	25
HNM-16	16	2.00	25

HEX NUTS GRADE 10.9

PART#	SIZE (MM)	PITCH	STD PKG
HNM10-6	6	1.00	100
HNM10-8	8	1.25	100
HNM10-10	10	1.50	100
HNM10-12	12	1.75	100
HNM10-14	14	2.00	50

NYLON INSERT LOCK NUTS

PART#	SIZE (MM)	PITCH	STD PKG
NNM-5	5	.80	100
NNM-6	6	1.00	100
NNM-8	8	1.25	100
NNM-10	10	1.50	50

FLAT WASHERS



PART#	SCREW SIZE	I.D.	STD PKG
FWM-4	4MM	4.3	100
FWM-5	5MM	5.3	100
FWM-6	6MM	6.4	100
FWM-8	8MM	8.4	100
FWM-10	10MM	10.5	100
FWM-12	12MM	13.0	100

LOCK WASHERS



PART#	SCREW SIZE	I.D.	STD PKG
LWM-4	4MM	4.1	100
LWM-5	5MM	5.1	100
LWM-6	6MM	6.1	100
LWM-8	8MM	8.1	100
LWM-10	10MM	10.2	100
LWM-12	12MM	12.2	100
LWM-14	14MM	14.2	100
LWM-16	16MM	16.2	100



DIAMETER THREAD	LENGTH	STD PKG	PHILLIPS PAN HEAD	PHILLIPS FLAT HEAD	PHILLIPS TRUSS HEAD	TYPE "F" HEX WASHER HEAD
#6-32 COARSE	1/2"	100	MSCPX-612			
	3/4"	100	MSCPX-634			
	1"	100	MSCPX-61			
	1-1/2"	100	MSCPX-6112			
#8-32 COARSE	1/2"	100	MSCPX-812			
	3/4"	100	MSCPX-834			
	1"	100	MSCPX-81			
	1-1/2"	100	MSCPX-8112			
#10-32 FINE	1/2"	100	MSFPX-1012			
	3/4"	100	MSFPX-1034			
	1"	100	MSFPX-101			
	1-1/2"	100	MSFPX-10112			
#10-24 COARSE	1/2"	100	MSCPX-1012			
	5/8"	100	MSCPX-1058			
	3/4"	100	MSCPX-1034			
	1"	100	MSCPX-101			
	1-1/4"	100	MSCPX-10114			
	1-1/2"	100	MSCPX-10112			
1/4-20 COARSE	1/2"	100	MSCPX-1412	MSCFX-1412	MSCTX-1412	MSCHWF-1412
	3/4"	100	MSCPX-1434	MSCFX-1434	MSCTX-1434	MSCHWF-1434
	1"	100	MSCPX-141	MSCFX-141	MSCTX-141	MSCHWF-141
	1-1/4"	100		MSCFX-14114		
	1-1/2"	100	MSCPX-14112	MSCFX-14112		
	2"	100	MSCPX-142	MSCFX-142		
5/16-18 COARSE	1/2"	50				MSCHWF-51612
	3/4"	50				MSCHWF-51634
	1"	50				MSCHWF-5161
3/8-16 COARSE	1"	50				MSCHWF-381

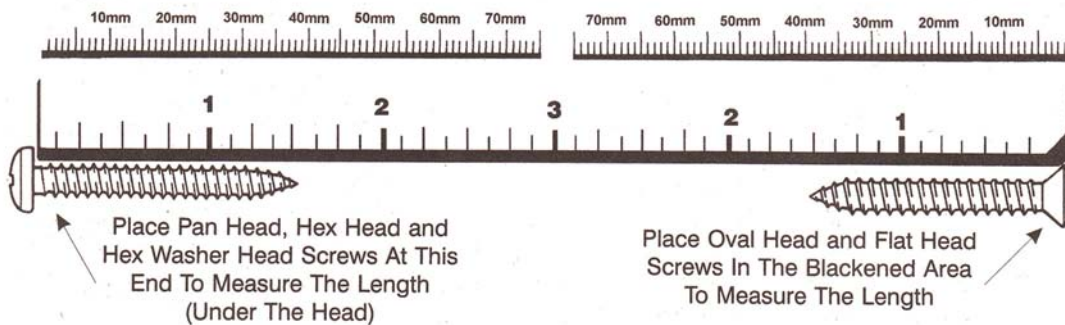

DIA	LENGTH	STD PKG	QUAD DRIVE			SQUARE DRIVE	
			PAN HEAD	PAN HEAD with /WASHER	FLAT HEAD	PAN HEAD	FLAT HEAD
#6	1/2"	100	SMSPQ-612				SMSFS-612
	3/4"	100	SMSPQ-634				
	1"	100				SMSPS-61	
	1-1/2"	100	SMSPQ-6112				
#8	3/8"	100	SMSPQ-838				
	1/2"	100	SMSPQ-812				SMSFS-812
	3/4"	100	SMSPQ-834	SMSPQW-812			SMSFS-834
	1"	100	SMSPQ-81	SMSPQW-81	SMSFQ-81		
	1-1/4"	100	SMSPQ-8114	SMSPQW-8114			SMSFS-8114
	1-1/2"	100	SMSPQ-8112	SMSPQW-8112	SMSFQ-8112		SMSFS-8112
	2"	100	SMSPQ-82	SMSPQW-82	SMSFQ-82		
	2-1/2"	100		SMSPQW-8212			SMSFS-8212
3"	100		SMSPQW-83			SMSFS-83	
#10	1/2"	100				SMSPS-1012	
	3/4"	100	SMSPQ-1034				
	1"	100	SMSPQ-101			SMSPS-10112	

QUAD DRIVE



PAN HEAD



PAN HEAD W/WASHER



FLATHEAD

SQUARE DRIVE



PAN HEAD



FLAT HEAD

DIA	LENGTH	STD PKG	QUAD DRIVE		SQUARE
			BRONZE w/WASHER PAN HEAD	WHITE PAN HEAD	BLACK PAN HEAD
#8	3/4"	100	SMSPQWBRZ-834	SMSPQWHT-834	
	1"	100	SMSPQWBRZ-81	SMSPQWHT-81	SMSPSBLK-81
	1-1/4"	100	SMSPQWBRZ-8114		
	1-1/2"	100	SMSPQWBRZ-8112	SMSPQWHT-8112	SMSPSBLK-8112
	2"	100	SMSPQWBRZ-82		
	2-1/2"	100	SMSPQWBRZ-8212		

PAN HEAD



BRONZE W/WASHER QUAD DRIVE



BLACK SQUARE DRIVE

DIA	LENGTH	STD PKG	HEX HEAD		PHILLIPS		
			HEX WASHER SLOTTED	HEX WASHER	PAN HEAD	BLACK OXIDE PAN HEAD	ROUNDHEAD WASHER BLACK
#8	1/2"	100	SMSHWI-812		SMSPX-812	SMSPXB-812	SMSRXWB-812
	5/8"	100			SMSPX-858		SMSRXWB-858
	3/4"	100	SMSHWI-834	SMSHW-834	SMSPX-834	SMSPXB-834	SMSRXWB-834
	1"	100		SMSHW-81	SMSPX-81	SMSPXB-81	SMSRXWB-81
	1-1/4"	100	SMSHWI-8114				
	1-1/2"	100	SMSHWI-8112		SMSPX-8112		SMSRXWB-8112
#10	1/2"	100	SMSHWI-1012	SMSHW-1012	SMSPX-1012	SMSPXB-1012	
	5/8"	100		SMSHW-1058	SMSPX-1058		
	3/4"	100	SMSHWI-1034		SMSPX-1034	SMSPXB-1034	
	1"	100	SMSHWI-101	SMSHW-101	SMSPX-101	SMSPXB-101	
	1-1/4"	100			SMSPX-10114		
	1-1/2"	100	SMSHWI-10112		SMSPX-10112		
#12	1/2"	100			SMSPX-1212		
	3/4"	100			SMSPX-1234		
	1"	100			SMSPX-121		
	1-1/4"	100			SMSPX-12114		
	1-1/2"	100			SMSPX-12112		
	2"	100			SMSPX-102		
1/4"	1/2"	100	SMSHWI-1412		SMSPX-1412		
	3/4"	100	SMSHWI-1434	SMSHW-1434	SMSPX-1434		
	1"	100	SMSHWI-141	SMSHW-141	SMSPX-141		
	1-1/4"	100		SMSHW-14114			
	1-1/2"	100	SMSHWI-14112	SMSHW-14112	SMSPX-14112		
	2"	100	SMSHWI-142		SMSPX-142		
5/16"	1/2"	100	SMSHWI-51612				
	3/4"	100	SMSHWI-51634				
	1"	50	SMSHWI-5161				
	1-1/4"	50	SMSHWI-516114				
	1-1/2"	50	SMSHWI-516112				

HEX HEAD



HEX WASHER SLOTTED



HEX WASHER

PHILLIPS



PAN HEAD



BLACK OXIDE PAN HEAD



ROUNDHEAD WASHER BLACK

—ZINC—



DIA	LENGTH	HEX HEAD W / WASHER	PAN PHILLIPS HEAD	ROUND PHILLIPS W / WASHER	PAN HEAD QUAD DRIVE
#6	3/8"	TS-638	TS-PX638		
	1/2"	TS-612	TS-PX612		
	3/4"	TS-634	TS-PX634		
1/4" Head	1"		TS-PX61		
#8	1/2"	TS-812	TS-PX812	TS-RXW812	TS-PSQ812
	3/4"	TS-834	TS-PX834	TS-RXW834	TS-PSQ834
	1"	TS-81	TS-PX81	TS-RXW81	TS-PSQ81
1/4" Head	1-1/4"	TS-8114			
	1-1/2"	TS-8112	TS-PX8112		TS-PSQ8112
#10	1/2"	TS-1012	TS-PX1012		
	3/4"	TS-1034	TS-PX1034		
	1"	TS-101	TS-PX101		
5/16" Head	1-1/4"	TS-10114			
	1-1/2"	TS-10112	TS-PX10112		
#12	2"	TS-102			
	3/4"	TS-1234			
	1"	TS-121			
5/16" Head	1-1/2"	TS-12112			
	2"	TS-122			
1/4"	3/4"	TS-1434			
	1"	TS-141			
	1-1/4"	TS-14114			
3/8" Head	1-1/2"	TS-14112			
	2"	TS-142			
	3"	TS-143*			

* - Std Pkg: 50

—BLACK—



DIA	LENGTH	HEX HEAD W / WASHER	PAN PHILLIPS HEAD	OVAL PHILLIPS W/BEAUTY WASHER	ROUND PHILLIPS W/WASHER
#8	1/2"	TSB-812	TSB-PX812		TSB-RXW812
	3/4"	TSB-834	TSB-PX834	TSB-BWX834	TSB-RXW834
	1"	TSB-81	TSB-PX81	TSB-BWX81	TSB-RXW81
1/4" Head	1-1/4"	TSB-8114			
	1-1/2"	TSB-8112	TSB-PX8112		
#10	1/2"	TSB-1012			
	3/4"	TSB-1034			
	1"	TSB-101			
1/4"	1"	TSB-141			
	1-1/2"	TSB-14112			

Stainless Steel

CAP SCREWS —COARSE THREAD—



PART#	SIZE	STD PKG
CSCS1412	1/4-20 x 1/2"	50
CSCS1434	1/4-20 x 3/4"	50
CSCS141	1/4-20 x 1"	50
CSCS14114	1/4-20 x 1-1/4"	50
CSCS14112	1/4-20 x 1-1/2"	50
CSCS14134	1/4-20 x 1-3/4"	25
CSCS142	1/4-20 x 2"	25
CSCS14212	1/4-20 x 2-1/2"	25
CSCS143	1/4-20 x 3"	25
CSCS51634	5/16-18 x 3/4"	25
CSCS5161	5/16-18 x 1"	25
CSCS516114	5/16-18 x 1-1/4"	25
CSCS516112	5/16-18 x 1-1/2"	25
CSCS5162	5/16-18 x 2"	25
CSCS516212	5/16-18 x 2-1/2"	25
CSCS5163	5/16-18 x 3"	25
CSCS381	3/8-16 x 1"	50
CSCS38114	3/8-16 x 1-1/4"	25
CSCS38112	3/8-16 x 1-1/2"	25
CSCS382	3/8-16 x 2"	25
CSCS38212	3/8-16 x 2-1/2"	25

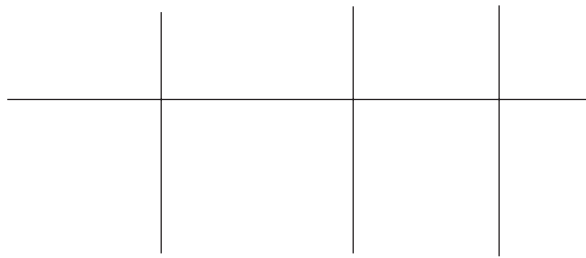

FENDER WASHERS



PART#	SIZE (ID)	SIZE (OD)	STD PKG
FNWS101	No. 10	1"	100
FNWS141	1/4"	1"	100
FNWS14114	1/4"	1-1/4"	100
FNWS516112	5/16"	1-1/2"	100
FNWS38112	3/8"	1-1/2"	100

Also Available in Fine Thread

COMMERCIAL FLAT WASHERS



PART#	SIZE	I.D. (A)	O.D. (B)	APPROXIMATE THICKNESS(C)	STD PKG
FWS6	No. 6	5-32"	3/8"	.030	100
FWS8	No. 8	3/16"	7/16"	.030	100
FWS10	No.10	7/32"	1/2"	.030	100
FWS12	No.12	1/4"	39/64"	.043	100
FWS1/4	1/4"	5/16"	47/64"	.043	100
FWS5/16	5/16"	3/8"	7/8"	.050	100
FWS3/8	3/8"	7/16"	1"	.060	100
FWS7/16	7/16"	1/2"	1-1/4"	.060	50
FWS1/2	1/2"	9/16"	1-3/8"	.060	50
FWS5/8	5/8"	11/16"	1-3/4"	.075	100

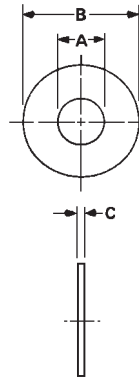

MEDIUM SPLIT LOCKWASHERS



PART#	SIZE	STD PKG
LWS6	No. 6	100
LWS8	No. 8	100
LWS10	No.10	100
LWS1/4	1/4"	100
LWS5/16	5/16"	100
LWS3/8	3/8"	100
LWS1/2	1/2"	100

HEX MACHINE SCREW NUTS



PART#	SIZE	APPROX HEX WIDTH	STD PKG
MNCS6	6-32	5/16"	100
MNCS8	8-32	11/32"	100
MNCS10	10-24	3/8"	100
MNFS10	10-32	3/8"	100
MNCS1/4	1/4-20	7/16"	100

HEX NUTS



PART#	SIZE	STD PKG
HNCS1/4	1/4-20	100
HNCS5/16	5/16-18	50
HNCS3/8	3/8-16	50
HNCS1/2	1/2-13	25

NYLON INSERT LOCK NUTS



NNCS6	6-32	50
NNCS8	8-32	50
NNCS10	10-24	50
NNFS10	10-32	50
NNCS1/4	1/4-20	50
NNFS1/4	1/4-28	50
NNCS5/16	5/16-18	50
NNFS5/16	5/16-24	100
NNCS3/8	3/8-16	25
NNFS3/8	3/8-24	25
NNCS7/16	7/16-14	25
NNCS1/2	1/2-13	10
NNFS1/2	1/2-20	25

MACHINE SCREWS



**PAN HEAD
PHILLIPS**



**OVAL HEAD
PHILLIPS**



**FLAT HEAD
PHILLIPS**

DIAMETER THREAD	LENGTH	STD PKG	PAN HEAD PHILLIPS	OVAL HEAD PHILLIPS	FLAT HEAD PHILLIPS
#6-32 COARSE	1/2"	100	MSCPXS612		
	3/4"	100	MSCPXS634		
	1"	100	MSCPXS61		
	1-1/2"	100	MSCPXS6112		
	2"	100	MSCPXS62		
#8-32 COARSE	1/2"	100	MSCPXS812	MSCOXS812	
	3/4"	100	MSCPXS834	MSCOXS834	
	1"	100	MSCPXS81	MSCOXS81	
	1-1/2"	100	MSCPXS8112		
	2"	100	MSCPXS82		
#10-32 FINE	1/2"	100	MSFPXS1012		
	3/4"	100	MSFPXS1034		
	1"	100	MSFPXS101		
	1-1/2"	100	MSFPXS10112		
	2"	100	MSFPXS102		
	2-1/2"	100	MSFPXS10212		
#10-24 COARSE	1/2"	100	MSCPXS1012	MSCOXS1012	
	3/4"	100	MSCPXS1034	MSCOXS1034	
	1"	100	MSCPXS101	MSCOXS101	
	1-1/2"	100	MSCPXS10112	MSCOXS10112	
	2"	100	MSCPXS102	MSCOXS102	
	2-1/2"	50	MSCPXS10212	MSCOXS10212	
	3"	50	MSCPXS103	MSCOXS103	
1/4-20 COARSE	1/2"	50	MSCPXS1412		
	3/4"	50	MSCPXS1434	MSCOXS1434	MSCFXS1434
	1"	50	MSCPXS141	MSCOXS141	MSCFXS141
	1-1/4"	50	MSCPXS14114	MSCOXS14114	
	1-1/2"	50	MSCPXS14112	MSCOXS14112	MSCFXS14112
	1-3/4"	50			MSCFXS14134
	2"	50	MSCPXS142	MSCOXS142	MSCFXS142
	2-1/2"	25	MSCPXS14212	MSCOXS14212	MSCFXS14212
	3"	25	MSCPXS143	MSCOXS143	
4"	25	MSCPXS144	MSCOXS144		

SHEET METAL SCREWS



**PAN HEAD
PHILLIPS**



**OVAL HEAD
PHILLIPS**



**FLAT HEAD
PHILLIPS**

DIAMETER THREAD	LENGTH	STD PKG	PAN HEAD PHILLIPS	OVAL HEAD PHILLIPS	FLAT HEAD PHILLIPS
#6	1/2"	100	SMSPXS612	SMSOXS612	
	5/8"	100	SMSPXS658		
	3/4"	100	SMSPXS634	SMSOXS634	SMSFXS634
	1"	100	SMSPXS61	SMSOXS61	SMSFXS61
	1-1/4"	100	SMSPXS6114		
	1-1/2"	100	SMSPXS6112	SMSOXS6112	
#8	1/2"	100	SMSPXS812	SMSOXS812	SMSFXS812
	5/8"	100	SMSPXS858		
	3/4"	100	SMSPXS834	SMSOXS834	SMSFXS834
	1"	100	SMSPXS81	SMSOXS81	SMSFXS81
	1-1/4"	100	SMSPXS8114	SMSOXS8114	SMSFXS8114
	1-1/2"	100	SMSPXS8112	SMSOXS8112	SMSFXS8112
#10	2"	100	SMSPXS82	SMSOXS82	
	1/2"	100	SMSPXS1012	SMSOXS1012	
	3/4"	100	SMSPXS1034	SMSOXS1034	SMSFXS1034
	1"	100	SMSPXS101	SMSOXS101	SMSFXS101
	1-1/4"	100	SMSPXS10114	SMSOXS10114	SMSFXS10114
	1-1/2"	100	SMSPXS10112	SMSOXS10112	SMSFXS10112
	2"	100	SMSPXS102	SMSOXS102	
#12	2-1/2"	50	SMSPXS10212		
	3"	50	SMSPXS103		
	1/2"	100	SMSPXS1212		
	3/4"	100	SMSPXS1234		
	1"	100	SMSPXS121	SMSOXS121	
#14	1-1/4"	100		SMSOXS12114	
	1-1/2"	50	SMSPXS12112	SMSOXS12112	
	2"	50	SMSPXS122	SMSOXS122	
	3/4"	100	SMSPXS1434		
	1"	100	SMSPXS141	SMSOXS141	SMSFXS141
#14	1-1/4"	50	SMSPXS14114		
	1-1/2"	50	SMSPXS14112	SMSOXS14112	SMSFXS14112
	2"	50	SMSPXS142	SMSOXS142	
	2-1/2"	50	SMSPXS14212	SMSOXS14212	
	3"	50	SMSPXS143	SMSOXS143	